

NIPPLEMAX

INSTRUCTION MANUAL

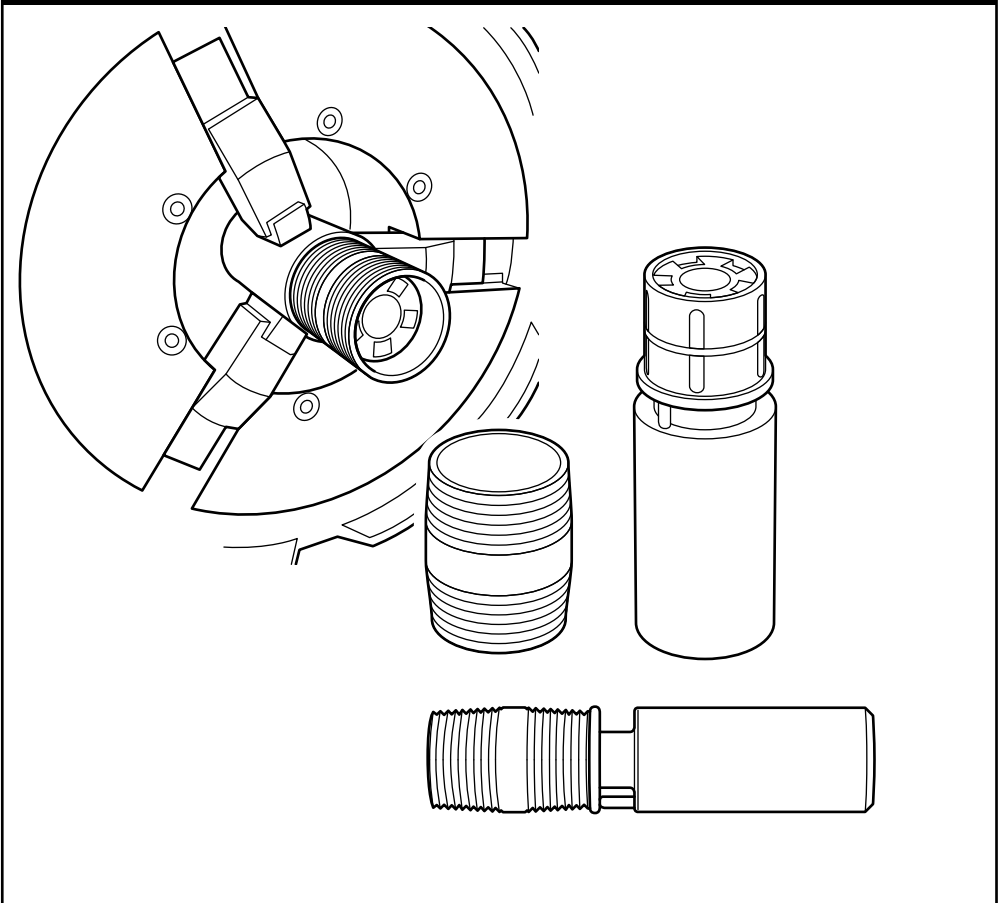

[Read through this manual carefully before using the tool]

Thank you for choosing our Nipplemax.

- This Instruction Manual must be retained by the user of this tool.
- Read this Instruction Manual carefully and completely before use and thoroughly understand the usage, capacity, cautions and easy repairs for correct operation.
- Handle the tool properly to make full use of its functions for safe work.
- After reading the instructions, save this manual so that you can read it when necessary.
- Use the tool for the intended application only. It will do a better job and be safer at the rate for which it was designed.
- Upon receiving the tool, check the following.

Check that the tool is built conforming to the specifications stated in your order.

Check the overall tool for any damage or deformation caused in transit due to accidents or other reasons.

Check that all items and accessories delivered.

In case any discrepancy is found, immediately report the fact to the shop you purchased or our sale office.

(The contents of this manual are subject to change without prior notice.)

How to Use Nipplemax

1. Ream the inner surface of the work piece with the Reamer of the threading machine, and cut threads on one side of the pipe.
2. Cut the work piece at the needed length.
3. Install the Nipplemax to the Hammer Chuck.
4. Insert the Nipplemax to the work piece from the threaded side.
5. Start thread cutting.
6. Remove the work piece after finishing thread cutting.

Main Parts

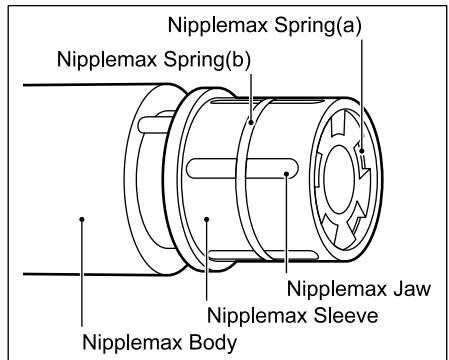

How to Replace Nipplemax Jaws

1. Pull down the Nipplemax Sleeve.
2. Remove the Nipplemax Spring(a) from the Nipplemax Body with a screw driver etc.
3. Pull up the Nipplemax Sleeve and take it out from the Nipplemax Body.
4. Remove the old Nipplemax Jaws and put the new Nipplemax Jaws on the Nipplemax Sleeve.
5. Put the Nipplemax Spring(a) to the Nipplemax Body.

Caution

1. Make sure the threaded side of the work piece is well reamed before inserting the Nipplemax.
2. Make sure the Nipplemax is fully inserted into the work piece.
3. Turn the switch on the threading machine while pressing the Dies to the work piece strongly..
4. Remove all small cutting dusts between the grooves on the Nipplemax Sleeve and the Nipplemax Jaws with a brush after use.

Asada
ASADA CORPORATION

3-60, Kamiida, Nishi-Machi, Kita-Ku, Nagoya, Japan 462-8551
TEL +81-52-914-1062 FAX +81-52-914-1144
URL <http://www.asada.co.jp> E-mail: trade@asada.co.jp

PRINT No.121100A